

# Bucket Elevator Chains

A bucket elevator is a conveyor in which buckets are installed on a vertically circulating chain, to vertically convey loads of granular powder. There are two series of bucket elevators: NE Type (standard speed) and NSE Type (high speed). Both types have wide-ranging applications.

## (a) NE Bucket Elevator Chains

An NE type bucket elevator is a general-use bucket elevator that operates at a normal conveyance speed. The elevator is manufactured with two types of chains: Standard Conveyor Chain with Attachment G4 (standard or heavy-duty) and DK Strong Z Conveyor Chain.

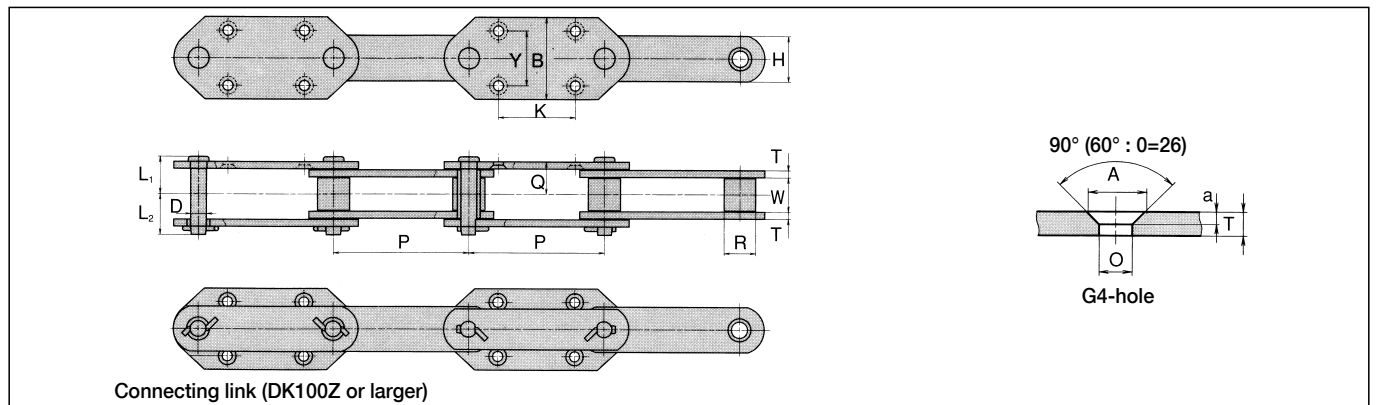

Chain No.	Type	Avg. tensile strength kN (kgf)		Pitch P	Roller link width W	Roller dia. R	Pin			Plate		Attachment					Flush bolt	Approx. weight (kg/m)			
		Standard	Heavy-duty				D	L <sub>1</sub>	L <sub>2</sub>	T	H	K	Y	B	O	A		Q	Without attachment	With Attachment G4	
		Unit (mm)																			
DK 19200M DK 19250M	Standard	186 (19,000)	279 (28,500)	200 250	36.5	38.1	15.90	40.4	47.1	8	45	100	80	125	14	27	35.5	M12	8.6 8.1	11.0 10.5	
DK 25200M DK 25250M		245 (25,000)	392 (40,000)	200 250	51.8	44.5	19.10	51.7	59.8	9	50	100 140	80	125	14	27	45.5	M12	11.9 11.0	14.6 13.7	
DK 32200M DK 32250M DK 32300M		313 (32,000)	500 (51,000)	200 250 300	57.6	50.8	22.20	55.7	62.8	9	65	100 140 170	80	125 150	18	33	48.5	M16	16.4 15.2 14.2	18.7 18.2 17.2	
DK 50250M DK 50300M		490 (50,000)	686 (70,000)	250 300	67.4	57.1	25.40	68.1	74.9	12	80	140 170	100	150	18	33	60	M16	25.2 23.3	28.7 26.8	
DK 65300M		588 (60,000)	882 (90,000)	300	75	63.5	28.00	81.2	88.8	16	75	170	100	160	22	39	72	M20	30.1	34.8	
DK 11152M		112 (11,500)	171 (17,500)	152.4	30.8	28.6	12.70	31.7	36.6	6	38	75	70	110	12	22	28.5	M10	5.8	7.4	
DK 19152M		186 (19,000)	279 (28,500)	152.4	36.5	38.1	15.90	40.4	47.1	8	45	75	70	110	14	27	35.5	M12	9.4	11.4	
DK 25152M		245 (25,000)	392 (40,000)	152.4	37.5	44.5	19.10	44.6	52.9	9	50	75	70	125	14	27	38.5	M12	12.6	15.2	
DK 35Z200M DK 35Z250M		Strong Z-type	—	392 (40,000)	200 250	51.8	44.5	22.20	53.8	60.2	9	57	100 140	80 100	125 150	14	27	45.5	M12	12.7 11.7	15.3 15.0
DK 50Z200M DK 50Z225M DK 50Z250M DK 50Z300M			—	588 (60,000)	200 225 250 300	57.6	50.8	25.40	57.3	64.2	9	75	100 120 140 170	80 125	18	33	48.5	M16	17.7 16.9 16.2 15.2	20.0 19.2 19.2 18.2	
DK 75Z200M DK 75Z250M DK 75Z300M DK 75Z350M			—	931 (95,000)	200 250 300 350	67.4	63.5	31.75	70.0	78.0	12	90	100 140 170 225	80 125	18	33	60	M16	31.0 28.0 26.0 24.6	33.3 31.5 29.5 28.1	
DK 100Z250M DK 100Z300M DK 100Z350M			—	1,225 (125,000)	250 300 350	75.0	70.0	35.00	83.2	90.8	16	100	140 170 225	100 120 180	18 22 39	33 72	M16 M20	42.5 39.5 37.2	47.3 45.6 43.2		
DK 120Z250M DK 120Z300M DK 120Z350M DK 120Z400M			—	1,470 (150,000)	250 300 350 400	82.5	75.0	38.50	88.0	95.5	16	115	140 170 225 260	120 180	18 22 39	33 76	M16 M20	50.6 46.8 43.7 41.6	56.2 52.3 49.2 48.7		
DK 140Z300M DK 140Z350M DK 140Z400M			—	1,667 (170,000)	300 350 400	85.0	82.0	41.75	90.2	99.3	16	125	170 225 260	140 210	26	42.2	77	M24	55.5 51.8 49.1	62.0 58.2 55.4	
DK 160Z300M DK 160Z350M DK 160Z400M			—	1,863 (190,000)	300 350 400	92.5	86.0	44.50	101.2	110.3	19	130	170 225 260	140 210	26	42.2	87	M24	68.4 63.8 60.3	75.7 71.0 67.4	
DK 200Z350M DK 200Z400M DK 200Z450M	—		2,255 (230,000)	350 400 450	95.0	97.0	50.80	103.3	114.0	19	150	200 260 290	180 250	26	42.2	88.5	M24	77.5 73.3 70.0	86.8 82.6 79.3		
DK 250Z350M DK 250Z400M	—		2,843 (290,000)	350 400	100.0	107.0	56.00	113.0	123.0	22	165	200 260	180 250	26	42.2	97	M24	101.6 92.5	110.7 101.7		

Note: Ask us for the delivery time.

DK Specialty  
Conveyor Chains

Specialized  
Application  
Conveyor Chain

**(b) NSE Bucket Elevator Chains**

An NSE type bucket elevator is designed for high speed conveyance and the speed is about double that of NE type. To withstand high speed operation and to reduce noise and shock, the chain pitch is one-half or less of that of the chains for NE type. To ensure high durability, pins, bushings and rollers are the same as those for strong Z type.

Use the specialty sprockets for NSE Bucket Elevator Chains.

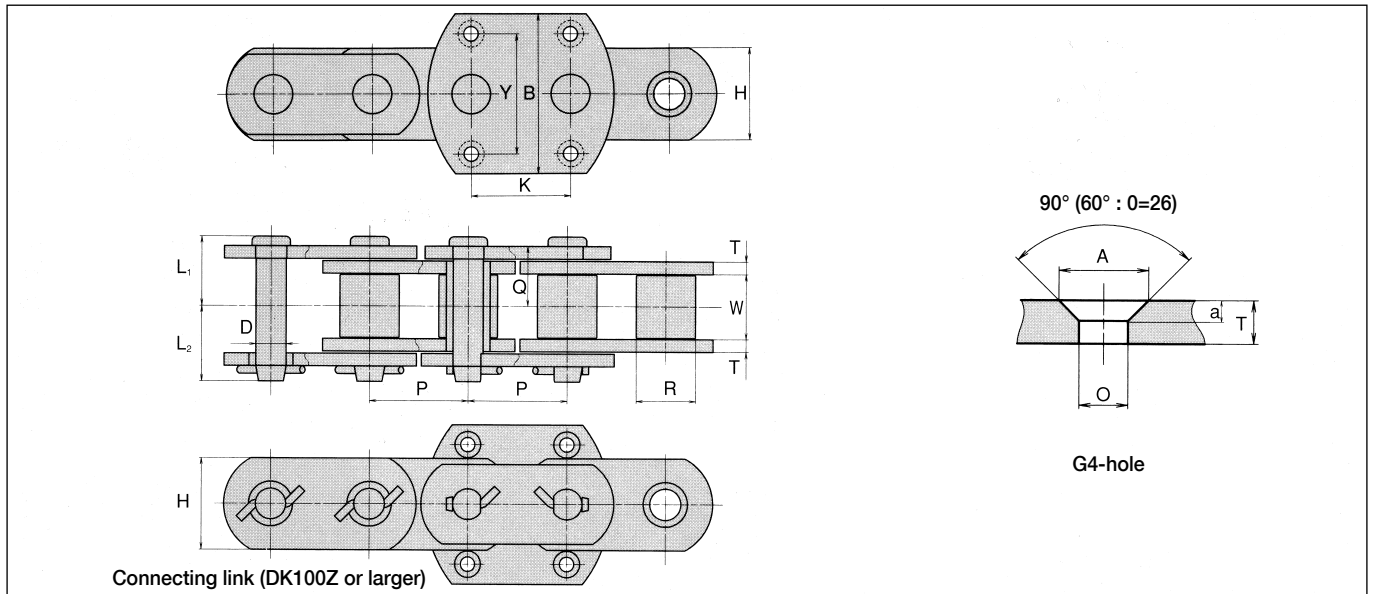
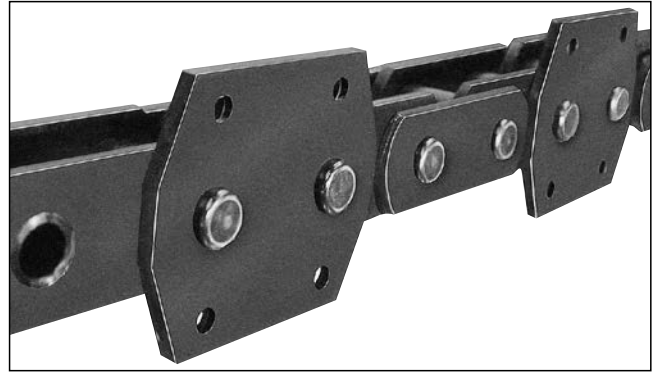

DK Specialty Conveyor Chains  
Specialized Application Conveyor Chain

Chain No.	Type	Avg. tensile strength		Pitch	Roller link width	Roller dia.	Pin			Plate		Attachment						Flush bolt	Approx. weight					
		Standard	Heavy-duty				P	W	R	D	L <sub>1</sub>	L <sub>2</sub>	T	H	K	Y	B		O	A	α	Q	Without attachment	With Attachment G4
							P	W	R	D	L <sub>1</sub>	L <sub>2</sub>	T	H	K	Y	B		O	A	α	Q		
<b>DK 19076M</b>	Standard	186 (19,000)	—	76.2	36.5	38.1	15.9	40.4	47.1	8	45	75	80	125	14	27	6.5	35	M12	13.1	17.0			
<b>DK 28076M</b>		274 (28,000)	—																					
<b>DK 23100M</b>		225 (23,000)	—	100	51.8	44.5	19.1	51.7	59.8	9	50	100	105	150	18	33	7.5	45.5	M16	17.5	20.4			
<b>DK 32100M</b>		313 (32,000)	—																			57.6	50.8	22.2
<b>DK 35Z100M</b>	Strong Z-type	—	392 (40,000)	100	51.8	44.5	22.2	53.8	60.2	9	57	100	105	150	18	33	7.5	45.5	M16	19.0	21.7			
<b>DK 50Z100M</b>		—	588 (60,000)																			125	57.6	50.8
<b>DK 50Z125M</b>		—	931 (95,000)	150	67.4	63.5	31.75	70	78	12	90	150	170	220	18	33	7.5	60	41.9	46.1				
<b>DK 75Z125M</b>		—	1,225 (125,000)																		175	82.5	75	38.5
<b>DK 75Z150M</b>		—	1,470 (150,000)	175	85	82	41.75	90.2	99.3	125	150	170	230	22	39	8.5	76	M20	62.5	69.4				
<b>DK 75Z175M</b>		—	1,667 (170,000)																		175	92.5	86	44.5
<b>DK 100Z125M</b>		—	1,863 (190,000)	175	95	97	50.8	103.5	114	150	195	175	180	250	26	42.2	14	88.5	M24	81.3				
<b>DK 100Z150M</b>		—	2,225 (230,000)																		175	95	97	50.8
<b>DK 100Z175M</b>		—	2,225 (230,000)	175	95	97	50.8	103.5	114	150	195	175	180	250	26	42.2	14	88.5	M24	91.6				
<b>DK 120Z125M</b>		—	1,470 (150,000)																		175	95	97	50.8
<b>DK 120Z150M</b>		—	1,667 (170,000)	175	95	97	50.8	103.5	114	150	195	175	180	250	26	42.2	14	88.5	M24	91.6				
<b>DK 120Z175M</b>		—	1,863 (190,000)																		175	95	97	50.8
<b>DK 140Z150M</b>	—	2,225 (230,000)	175	95	97	50.8	103.5	114	150	195	175	180	250	26	42.2	14	88.5	M24	91.6	99.9				
<b>DK 140Z175M</b>	—	2,225 (230,000)																			175	95	97	50.8
<b>DK 160Z175M</b>	—	2,225 (230,000)	175	95	97	50.8	103.5	114	150	195	175	180	250	26	42.2	14	88.5	M24	91.6	99.9				
<b>DK 200Z175M</b>	—	2,225 (230,000)																			175	95	97	50.8

Note: 1. Pins for DK 23100M and DK 32100M are both-side notched pins. 2. Ask us for the delivery time.